

AIRGOMIG GUN POWER PIN CONNECTION

Version 2021-12-03

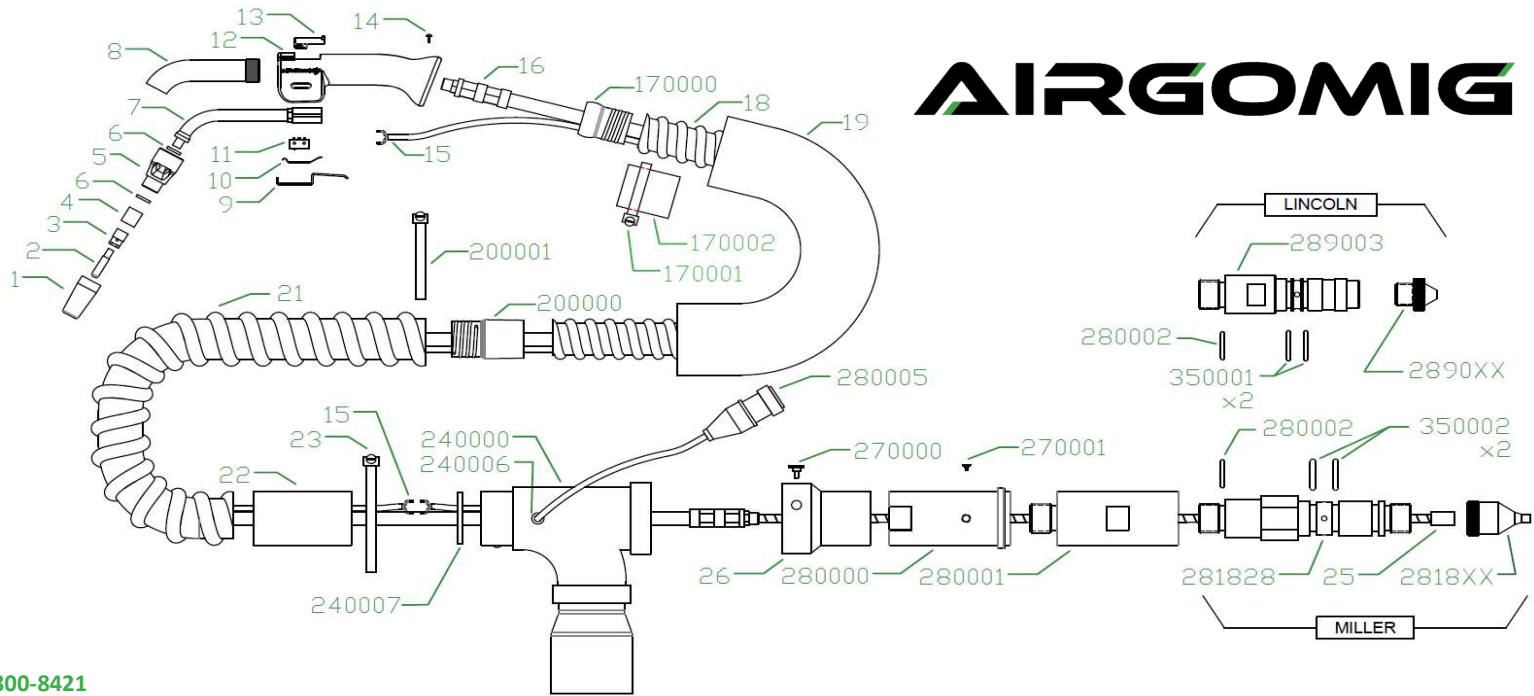

info@airgomig.com / 1 866-800-8421

#	PART	DESCRIPTION	#	PART	DESCRIPTION	#	PART	DESCRIPTION
		----- GAS NOZZLES -----			----- HANDLES AND ACCESSORIES -----	23	230000	HOSE RING CLAMP ON TEE
1	01C050	GAS NOZZLE - Cu - Ø 1/2"	9	090000	STAINLESS STEEL TRIGGER - STANDARD	24	240000	VACUUM TEE CONNECTOR Ø 2" - ASSEMBLED
	01C063	GAS NOZZLE - Cu - Ø 5/8"		090001	STAINLESS STEEL TRIGGER - LONG		240006	GROMMET FOR PVC TEE
	01C075	GAS NOZZLE - Cu - Ø 3/4"		100000	TRIGGER SPRING		240007	4" BLACK TIE WRAP
	01Z050	GAS NOZZLE - CuCrZr - Ø 1/2"		110000	MICROSWITCH			----- WIRE LINERS -----
	01Z063	GAS NOZZLE - CuCrZr - Ø 5/8"		120300	300A HANDLE - ASSEMBLED	25S457	WIRE LINER 17' LONG STANDARD - Ø 0.030 - 0.045 - BLUE	
	01Z075	GAS NOZZLE - CuCrZr - Ø 3/4"		120400	400A HANDLE - ASSEMBLED	25S637	WIRE LINER 17' LONG STANDARD - Ø 0.052 - 0.063 (1/16") - RED	
		----- CONTACT TIPS -----	120500	500A HANDLE - ASSEMBLED	25S947	WIRE LINER 17' LONG STANDARD - Ø 0.078 - 0.094 (3/32") - BLACK		
2	02Z035	CONTACT TIP - CuCrZr - 0.035	130000	HANDLE VENT LATCH	25S455	WIRE LINER 25' LONG STANDARD - Ø 0.030 - 0.045 - BLUE		
	02Z045	CONTACT TIP - CuCrZr - 0.045	140004	PACK OF 5 HANDLE SCREWS (M3.5 X 16MM)	25S635	WIRE LINER 25' LONG STANDARD - Ø 0.052 - 0.063 (1/16") - RED		
	02Z052	CONTACT TIP - CuCrZr - 0.052		----- ELECTRICAL CABLES -----	25N457	WIRE LINER 17' LONG NYLATRON - Ø 0.030 - 0.045 - BLUE		
	02Z063	CONTACT TIP - CuCrZr - 0.063 (1/16")	150012	CONTROL CABLE - for 12' gun	25N637	WIRE LINER 17' LONG NYLATRON - Ø 0.052 - 0.063 (1/16") - RED		
	02Z094	CONTACT TIP - CuCrZr - 0.094 (3/32")	150015	CONTROL CABLE - for 15' gun	25N455	WIRE LINER 25' LONG NYLATRON - Ø 0.030 - 0.045 - BLUE		
	02CT35	CONTACT TIP - Cu - 0.035 TAPER	160312	POWER CABLE 300A - for 12' gun	25N635	WIRE LINER 25' LONG NYLATRON - Ø 0.052 - 0.063 (1/16") - RED		
3	02ZT35	CONTACT TIP - CuCrZr - 0.035 TAPER	160315	POWER CABLE 300A - for 15' gun		----- CONNECTIONS -----		
	02ZT45	CONTACT TIP - CuCrZr - 0.045 TAPER	160412	POWER CABLE 400A - for 12' gun	26	260000	ADAPTOR FITTING BLOCK TEE	
		----- GAS DIFFUSORS -----	160415	POWER CABLE 400A - for 15' gun	27	270000	BRASS SCREW M6 X 1	
	030000	GAS DIFFUSOR	160512	POWER CABLE 500A - for 12' gun		270001	STEEL SCREW M4 X 0.7	
		----- FUME SHROUD AND INSULATOR -----	160515	POWER CABLE 500A - for 15' gun	280000	COUPLING BLOCK - POWER PIN		
	4	040001	DIFFUSOR INSULATOR FLAT		----- VACUUM CONNECTIONS -----	280001	POWER PIN EXTENSION (OPTION)	
050000		FUME SHROUD - STANDARD	170000	SPHERICAL COUPLER Ø 1.75"	280002	O-RING FOR POWER PIN SEAT		
050001		FUME SHROUD - TULIP	170001	SPRING CLAMP FOR SPHERICAL COUPLER	280005	2 PIN PLUG FOR REEL CONNECTION		
5		----- SWAN NECKS AND INSULATOR -----	170002	HEAT SHRINK 2" X 2.5"	281828	POWER PIN - MILLER		
	060000	SWAN NECK INSULATOR	180000	HOSE Ø 1.75" (3 feet per gun)	281845	GUIDE FOR POWER PIN MILLER (0.024-0.045)		
	07S045	SWAN NECK 45°	190050	STANDARD HOSE PROTECTION - lg 5'	281863	GUIDE FOR POWER PIN MILLER (0.045-0.063)		
7	07L045	SWAN NECK 45° Long	190100	STANDARD HOSE PROTECTION - lg 10'	281894	GUIDE FOR POWER PIN MILLER (0.094)		
	07S060	SWAN NECK 60°	190150	STANDARD HOSE PROTECTION - lg 15'	289003	POWER PIN - LINCOLN		
		----- OUTER NECKS -----	200000	HOSE COUPLER - Ø 1.75" @ Ø 2"	289045	GUIDE FOR POWER PIN LINCOLN (0.024-0.045)		
8	08S045	OUTER NECK 45°	200001	SPRING CLAMP FOR ADAPTEUR Ø 1.75" @ Ø 2"	289063	GUIDE FOR POWER PIN LINCOLN (0.045-0.063)		
	08L045	OUTER NECK 45° LONG	210000	REINFORCED HOSE Ø 2" (see below to calculate) Length : 89" for the first 12" and then 12" per feet	289094	GUIDE FOR POWER PIN LINCOLN (0.094)		
	08S060	OUTER NECK 60°	220000	HOSE BEND RESTRICTOR	350001	O-RING FOR MILLER REEL ADAPTOR		
					350002	O-RING FOR MILLER REEL ADAPTOR		